

| PT # | Northing | Easting | Elev | Description |
|------|----------|----------|--------|---|
| 1604 | 49992.96 | 49967.55 | 3982.3 | E 1/4 Cor Sec 33 |
| 1602 | 47304.26 | 49999.72 | | SE Cor Sec 33 |
| 156 | 47290.23 | 47350.04 | | S 1/4 COR SEC 33 |
| 82 | 47276.73 | 44701.46 | 3988.6 | SW Cor Sec 33 |
| 141 | 52362.93 | 44638.79 | 3988.5 | NW Cor Sec 33 |
| 142 | 55242.35 | 44608.30 | | W 1/4 Cor Sec 28 |
| 143 | 57909.61 | 44576.35 | | NW Cor Sec 28 |
| 953 | 50176.80 | 47091.36 | 3991.2 | Ctrl Pt "BO" |
| 809 | 49309.37 | 45391.31 | 3994.0 | Ctrl Pt "DUNE II" Hub/Tack |
| 273 | 54166.95 | 44620.65 | 3998.5 | Ctrl Pt "POT" |
| 2059 | 52700.96 | 44593.91 | | Ctrl Pt "KNDB" Rebar/SEA Cap |
| 1603 | 48355.42 | 49959.28 | | WP-L |
| 1624 | 50503.98 | 49961.96 | 3981.1 | USGS Monument |
| 2056 | 53327.99 | 46639.27 | 3980.4 | Well 37-28: Proposed |
| 2167 | 51429.23 | 46289.64 | 3976.4 | Well 32-33: Production |
| 2068 | 52318.82 | 46906.00 | 3982.0 | Well 41-33: Production |
| 2169 | 52470.24 | 46848.03 | 3981.5 | Well 41A-33: Production |
| 2073 | 50153.98 | 49805.18 | 3975.8 | Well 84-33: Production |
| 2171 | 50326.32 | 49327.01 | 3972.9 | Well 84A-33: Production |
| 2172 | 50369.40 | 49419.53 | 3972.5 | Well 84B-33: Production |
| 2055 | 54849.05 | 46788.76 | 3973.3 | Well 45-28: Injection |
| 2054 | 55927.51 | 47299.22 | 3977.2 | Well 53-28: Injection |
| 2057 | 53356.85 | 43851.41 | 3987.4 | Well 77-29: Injection |
| 2058 | 53876.18 | 44165.21 | 3982.7 | Well 87-29: Injection |
| 2070 | 50512.46 | 48543.23 | 3979.3 | Well 64-33: Injection |
| 2075 | 52093.01 | 49640.46 | 3973.7 | Well 81-33: Injection |
| 2065 | 49617.34 | 47610.95 | 3985.6 | Well 55-33: Observation |
| 2076 | 50818.23 | 50739.41 | | Well BD-1: Observation |
| 2074 | 50158.80 | 49907.64 | | Well SW-1: Sweetwater |
| 2053 | 55927.74 | 45945.50 | 3978.5 | Well 33-28: Abandoned |
| 2052 | 56978.82 | 47835.75 | 3979.7 | Well 52-28: Abandoned |
| 2060 | 52447.15 | 44736.60 | 3981.9 | Well 11A-33: Abandoned |
| 2063 | 49718.61 | 45666.14 | 3994.9 | Well 25-33: Abandoned |
| 2064 | 49615.76 | 46949.59 | 3983.6 | Well 45-33: Abandoned |
| 0001 | 49652.32 | 46986.63 | 3985.3 | Well 45a-33: Production (Elevation at top of uppermost flange) |
| 0002 | 52451.23 | 47017.18 | 3984.8 | Well 41b-33: Production (Elevation at top of uppermost flange) |
| 0003 | 51578.25 | 45442.90 | 3982.3 | Well 22-33: Production (Elevation at top of welded steel plate) |

* ELEVATION TAKEN AT SE CORNER OF CELLAR
 ** ELEVATION TAKEN AT SW CORNER OF CELLAR
 *** WELLS SURVEYED AND MAPPED OCT 2, 2009 (incorporated with data from Sept. 1994 mapping of reaminging of remaining wells.)

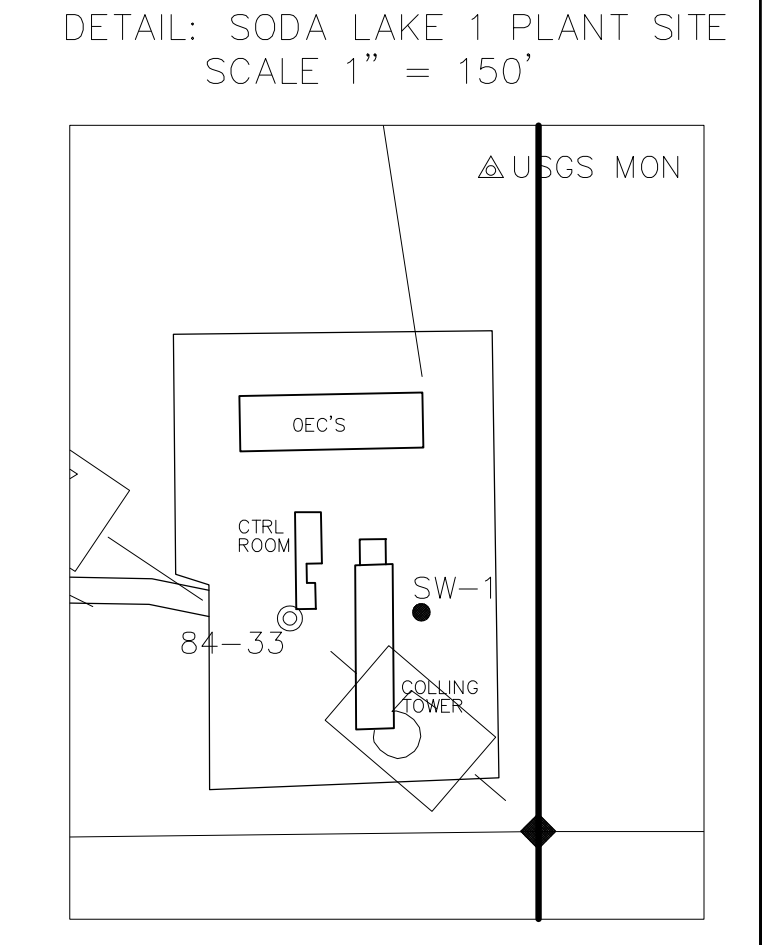

- ### LEGEND
- PRODUCTION WELL
 - ∅ INJECTION WELL
 - OBSERVATION WELL
 - ⊗ PLUGGED & ABANDONED WELL
 - ⊠ PROPOSED WELL
 - SWEETWATER WELL
 - ⬤ AUGER HOLE
 - ◇ FOUND SECTION CORNER
 - ◆ FOUND 1/4 SECTION CORNER
 - ▲ MISCELLANEOUS MONUMENT
 - 7 KETTLEMAN COORDINATE
 - == IMPROVED ROAD
 - - - UNIMPROVED ROAD
 - - - 4 WHEEL DRIVE TRAIL

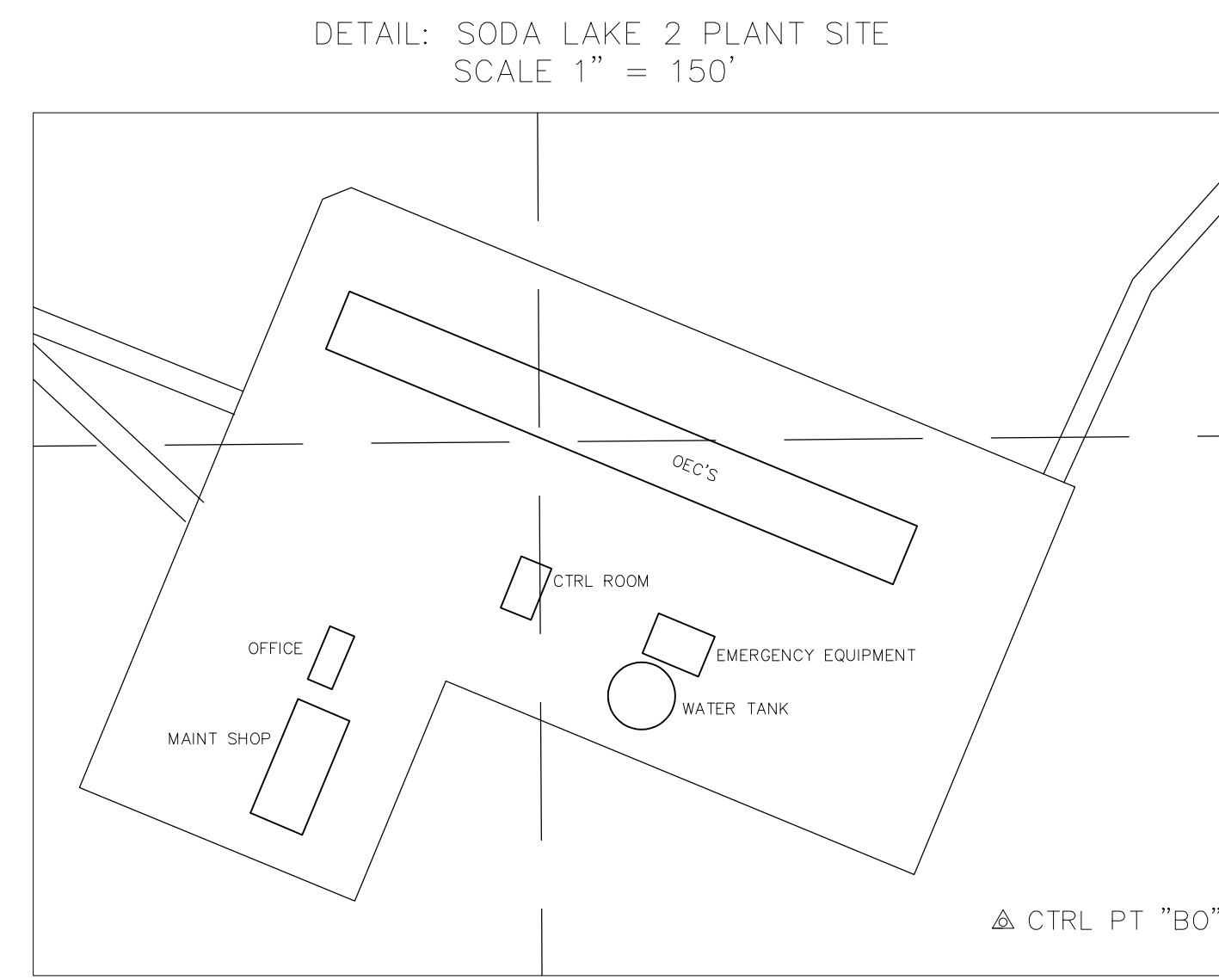
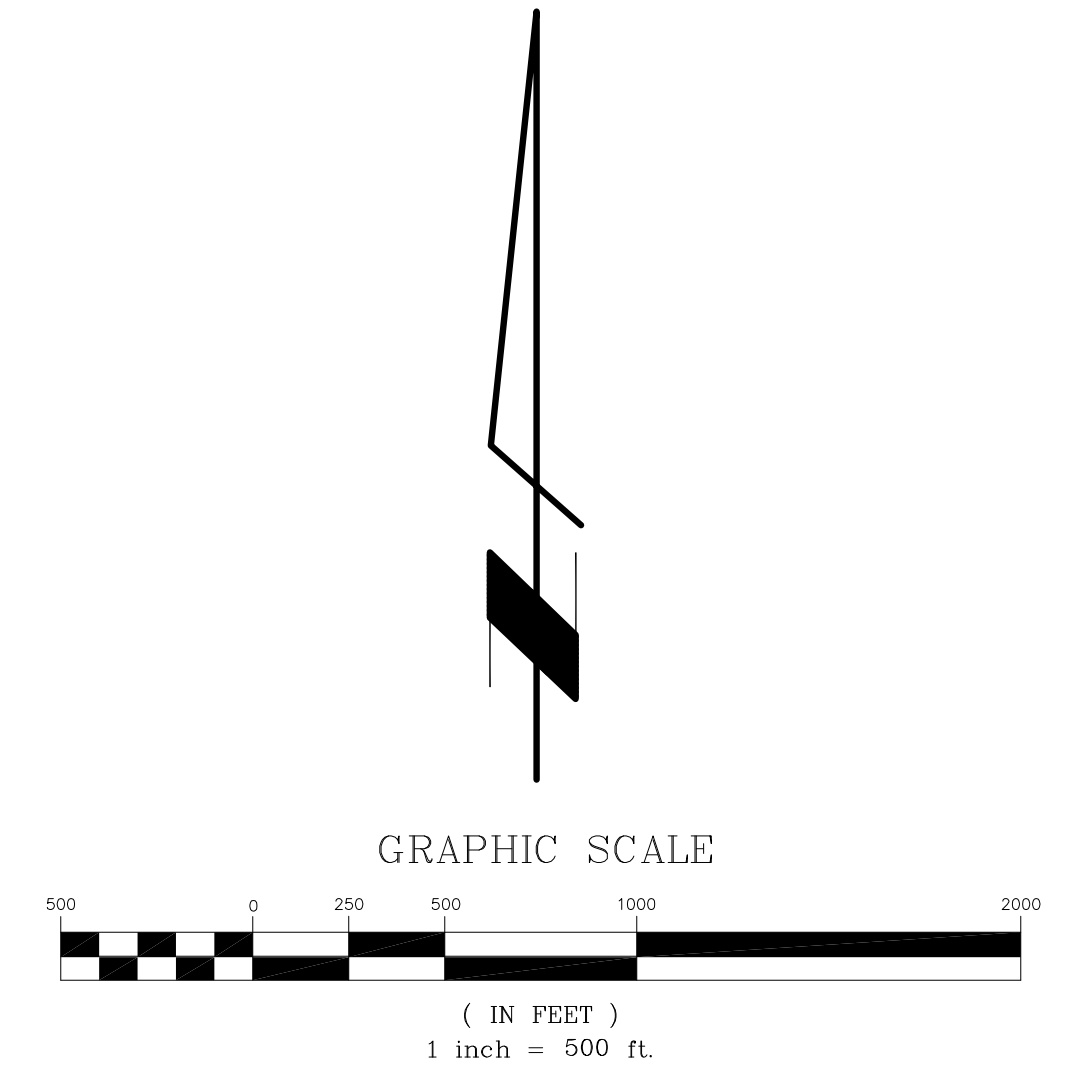

BASIS OF BEARINGS
 THE WEST LINE SEC 33, T20N, R28E, MDM
 BEARS: N 00°40'34" W.

| NO. | DESCRIPTION/DATE | BY |
|-----|------------------|----|
| | | |
| | | |
| | | |
| | | |
| | | |
| | | |
| | | |
| | | |
| | | |
| | | |

Stantec Consulting Inc.
 6980 Sierra Center Parkway #100
 Reno, NV 89511 USA
 Tel: (775) 850-0777
 Fax: (775) 850-0787
 stantec.com



SODA LAKE GEOTHERMAL PROJECTS CONTROL MAP

OF WELLS LOCATED IN:
 SECTIONS 28, 29, 33 & 34, T20N, R28E, MDB&M

| | |
|-----------|-----------|
| JOB NO. | 180401364 |
| ACAD FILE | SDDALAKE |
| DESIGNED | KSK/CJC |
| DRAWN | AutoCAD |
| CHECKED | |
| DATE | OCT 2009 |